



EG000020

EC002704

Fusibles cilíndricos de acción rápida con alto poder de ruptura para protección de líneas.



## CARACTERÍSTICAS ELÉCTRICAS

- ✓ Voltaje: 690 Vac / 700 Vdc.
- ✓ Rango de corriente: 1A – 100A.
- ✓ Poder de corte: 200 kA (690 Vac) – 30 kA (700 Vdc).
- ✓ Clase de servicio: aR.

## CARACTERÍSTICAS CONSTRUCTIVAS

- ✓ Cuerpo de radiocerámica MgO de alta resistencia.
- ✓ Como medio de extinción del arco se utiliza arena de cuarzo de alta pureza SiO<sub>2</sub> tratada químicamente.
- ✓ Contactos de aleación de cobre bañados en níquel.



IEC/EN-60269-1  
IEC/EN-60269-4



## ESPECIFICACIONES GENERALES

| Artículo                | Código  | Embalaje | Tensión (Vac/Vdc) | Poder corte (kA) |
|-------------------------|---------|----------|-------------------|------------------|
| ZR-0 (10x38) aR de 1 A  | 0115100 | 10       | 690/700           | 200/30           |
| ZR-0 (10x38) aR de 2 A  | 0115101 | 10       | 690/700           | 200/30           |
| ZR-0 (10x38) aR de 4 A  | 0115102 | 10       | 690/700           | 200/30           |
| ZR-0 (10x38) aR de 6 A  | 0115103 | 10       | 690/700           | 200/30           |
| ZR-0 (10x38) aR de 8 A  | 0115104 | 10       | 690/700           | 200/30           |
| ZR-0 (10x38) aR de 10 A | 0115105 | 10       | 690/700           | 200/30           |
| ZR-0 (10x38) aR de 12 A | 0115106 | 10       | 690/700           | 200/30           |
| ZR-0 (10x38) aR de 16 A | 0115107 | 10       | 690/700           | 200/30           |
| ZR-0 (10x38) aR de 20 A | 0115108 | 10       | 690/700           | 200/30           |
| ZR-0 (10x38) aR de 25 A | 0115109 | 10       | 690/700           | 200/30           |
| ZR-0 (10x38) aR de 32 A | 0115110 | 10       | 690/700           | 200/30           |
| ZR-1 (14x51) aR de 4 A  | 0115111 | 10       | 690/700           | 200/30           |
| ZR-1 (14x51) aR de 6 A  | 0115112 | 10       | 690/700           | 200/30           |
| ZR-1 (14x51) aR de 8 A  | 0115113 | 10       | 690/700           | 200/30           |
| ZR-1 (14x51) aR de 10 A | 0115114 | 10       | 690/700           | 200/30           |
| ZR-1 (14x51) aR de 12 A | 0115115 | 10       | 690/700           | 200/30           |
| ZR-1 (14x51) aR de 16 A | 0115116 | 10       | 690/700           | 200/30           |
| ZR-1 (14x51) aR de 20 A | 0115117 | 10       | 690/700           | 200/30           |
| ZR-1 (14x51) aR de 25 A | 0115118 | 10       | 690/700           | 200/30           |
| ZR-1 (14x51) aR de 32 A | 0115119 | 10       | 690/700           | 200/30           |

## ESPECIFICACIONES GENERALES

| Artículo                 | Código  | Embalaje | Tensión (Vac/Vdc) | Poder corte (kA) |
|--------------------------|---------|----------|-------------------|------------------|
| ZR-1 (14x51) aR de 40 A  | 0115120 | 10       | 690/700           | 200/30           |
| ZR-1 (14x51) aR de 50 A  | 0115121 | 10       | 690/700           | 200/30           |
| ZR-2 (22x58) aR de 20 A  | 0115122 | 5        | 690/700           | 200/30           |
| ZR-2 (22x58) aR de 25 A  | 0115123 | 5        | 690/700           | 200/30           |
| ZR-2 (22x58) aR de 32 A  | 0115124 | 5        | 690/700           | 200/30           |
| ZR-2 (22x58) aR de 40 A  | 0115125 | 5        | 690/700           | 200/30           |
| ZR-2 (22x58) aR de 50 A  | 0115126 | 5        | 690/700           | 200/30           |
| ZR-2 (22x58) aR de 63 A  | 0115127 | 5        | 690/700           | 200/30           |
| ZR-2 (22x58) aR de 80 A  | 0115128 | 5        | 690/700           | 200/30           |
| ZR-2 (22x58) aR de 100 A | 0115129 | 5        | 690/700           | 200/30           |

## DIMENSIONES (mm)

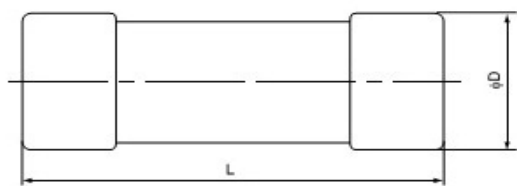

| TIPO  | ØD x L       | Peso (gr) |
|-------|--------------|-----------|
| ZR-00 | Ø 8.5 x 31.5 | 4.4       |
| ZR-0  | Ø 10.3 x 38  | 7.7       |
| ZR-1  | Ø 14.3 x 51  | 20.5      |
| ZR-2  | Ø 22.2 x 58  | 58        |

## CURVA TIEMPO-CORRIENTE – 10.3x38

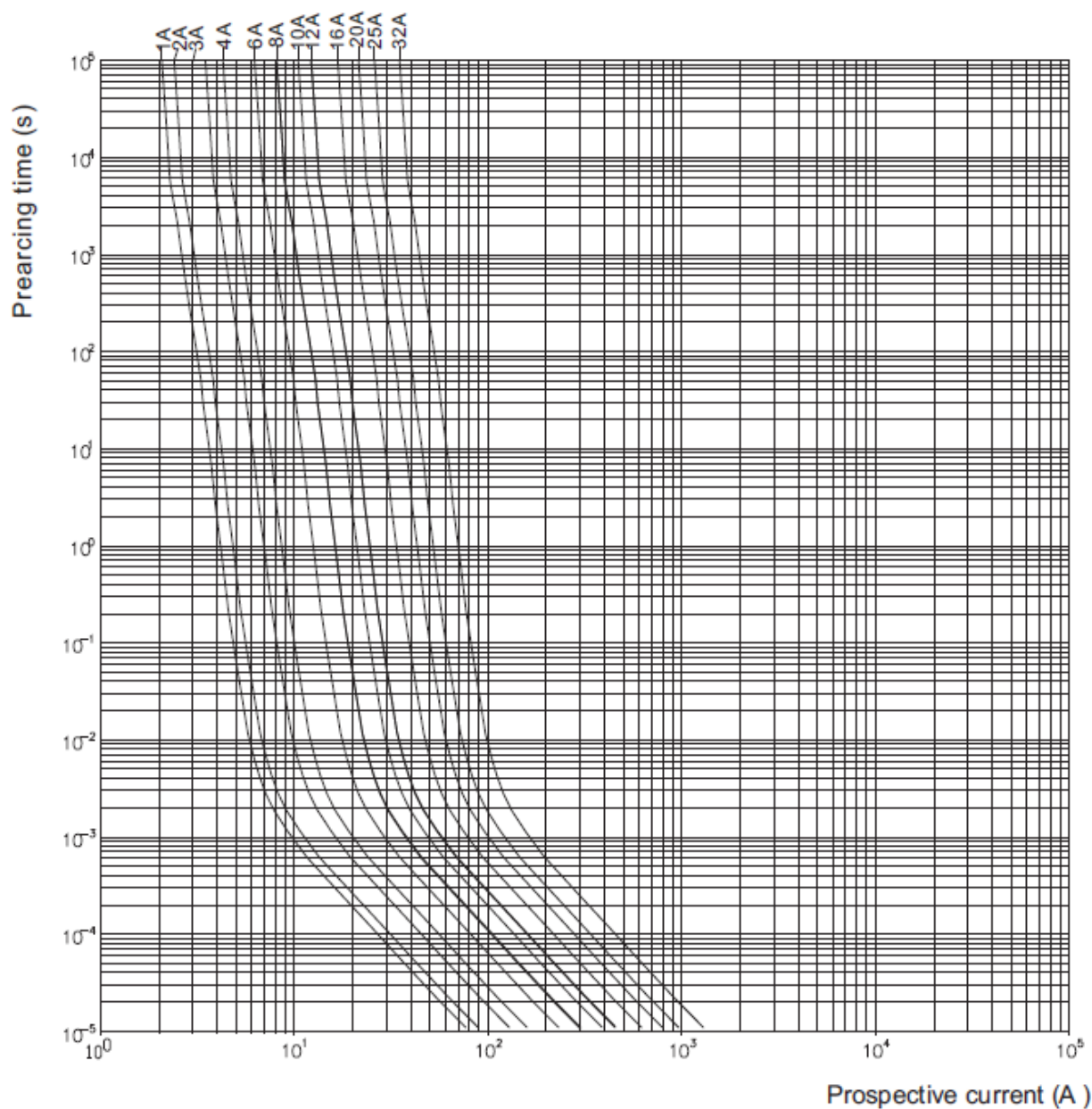

## CURVA TIEMPO-CORRIENTE – 14.3x51

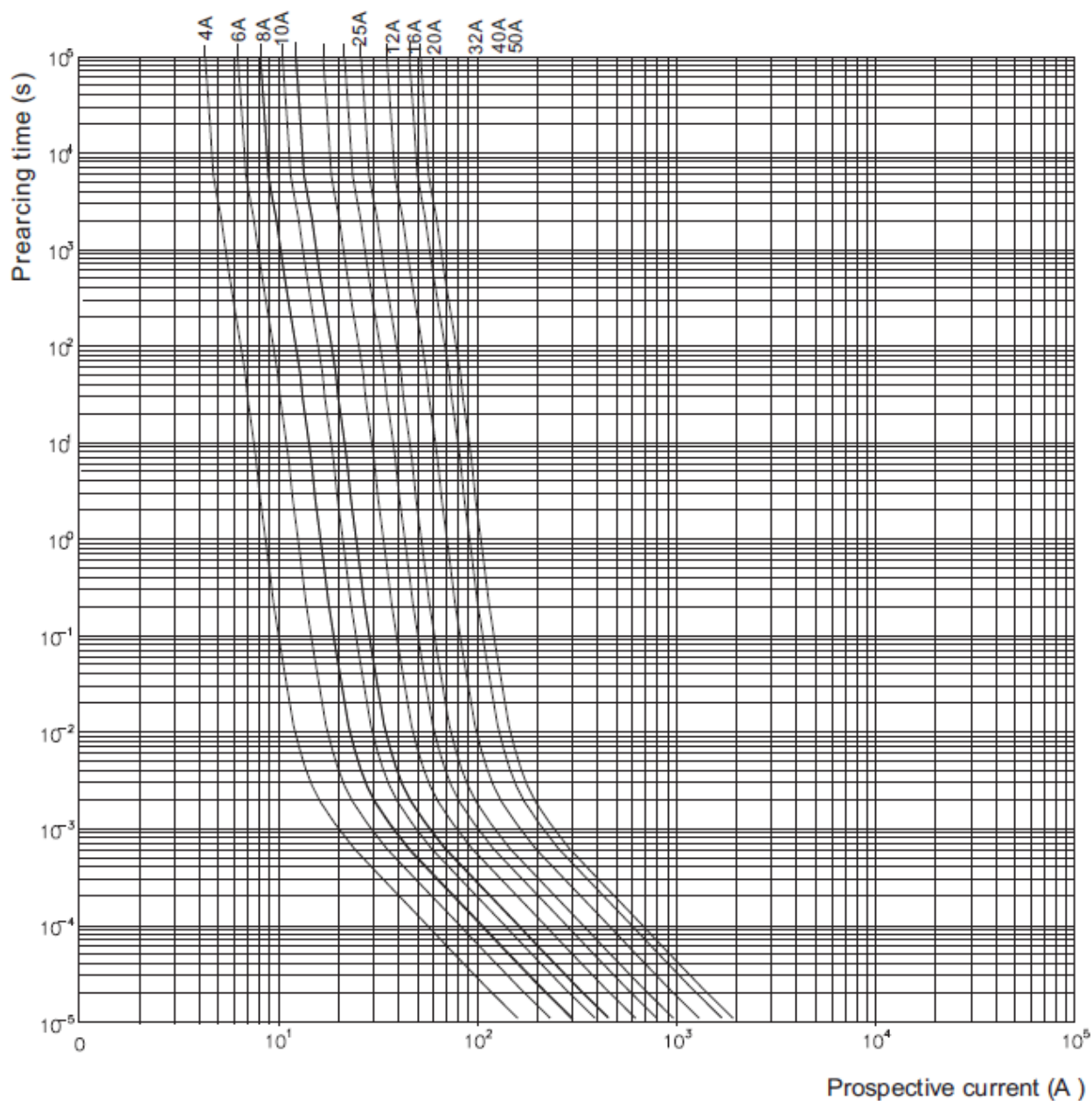

## CURVA TIEMPO-CORRIENTE – 22.2x58

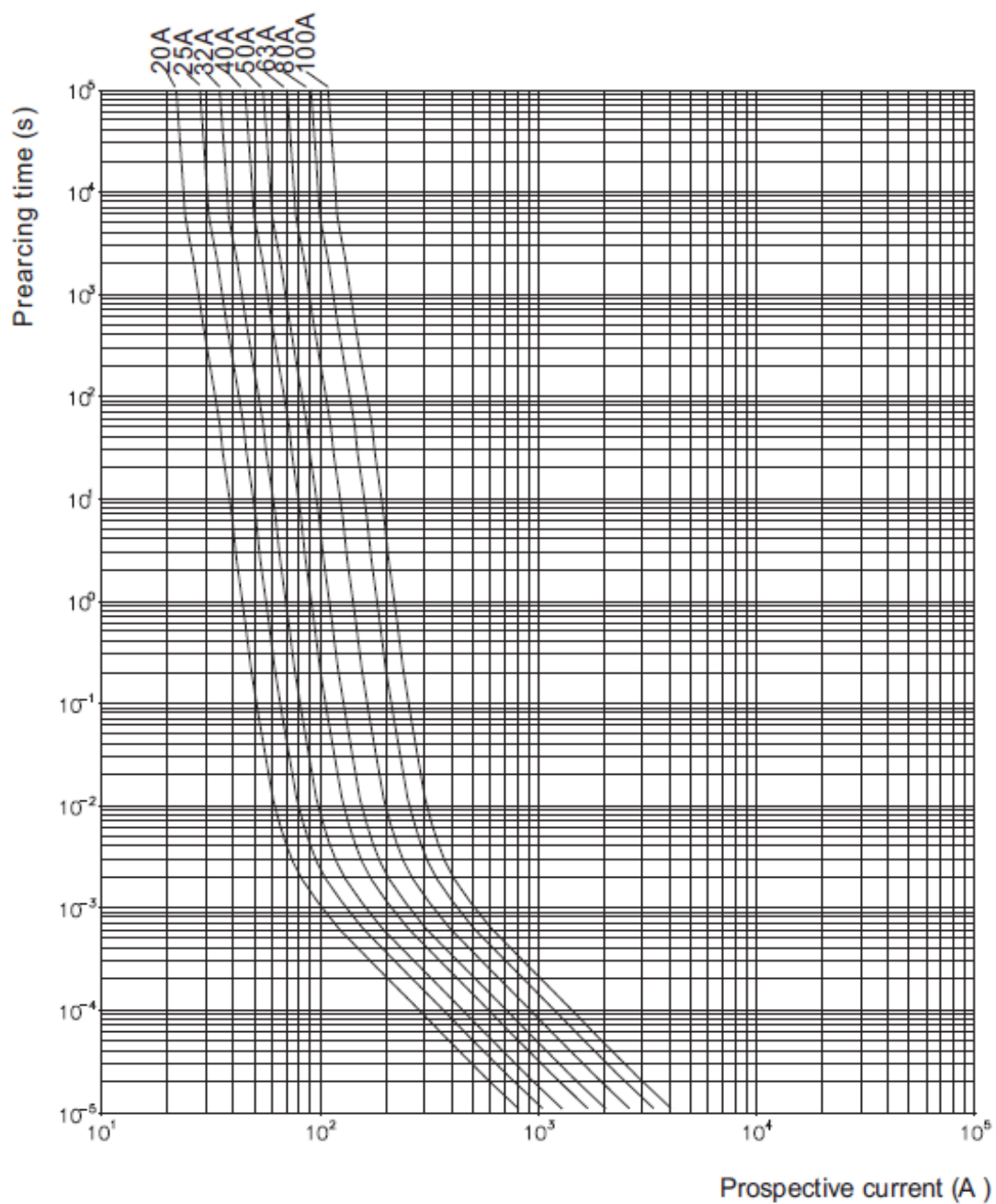

## ESPECIFICACIONES TÉCNICAS

| Tipo            | Tensión nominal | Corriente nominal | I <sup>2</sup> (A <sup>2</sup> S) Prearco | Potencia disipada (W) |
|-----------------|-----------------|-------------------|---|-----------------------|
| ZR-0<br>(10x38) | 690 V           | 1A                | 1.5                                       | 7                     |
|                 |                 | 2A                | 2.8                                       | 7                     |
|                 |                 | 4A                | 12  | 7                     |
|                 |                 | 6A                | 30  | 7                     |
|                 |                 | 8A                | 32  | 7                     |
|                 |                 | 10A               | 36  | 7                     |
|                 |                 | 12A               | 58  | 7                     |
|                 |                 | 16A               | 100                                       | 7                     |
|                 |                 | 20A               | 187                                       | 7                     |
|                 |                 | 25A               | 400                                       | 7                     |
|                 |                 | 32A               | 650                                       | 7                     |
| ZR-1<br>(14x51) | 690 V           | 4A                | 16  | 20                    |
|                 |                 | 6A                | 38  | 20                    |
|                 |                 | 8A                | 40  | 20                    |
|                 |                 | 10A               | 47  | 20                    |
|                 |                 | 12A               | 58  | 20                    |
|                 |                 | 16A               | 78  | 20                    |
|                 |                 | 20A               | 126                                       | 20                    |
|                 |                 | 25A               | 224                                       | 20                    |
|                 |                 | 32A               | 483                                       | 20                    |
|                 |                 | 40A               | 865                                       | 20                    |
|                 |                 | 50A               | 1650                                      | 20                    |
| ZR-2<br>(22x58) | 690 V           | 20A               | 110                                       | 40                    |
|                 |                 | 25A               | 195                                       | 40                    |
|                 |                 | 32A               | 356                                       | 40                    |
|                 |                 | 40A               | 523                                       | 40                    |
|                 |                 | 50A               | 884                                       | 40                    |
|                 |                 | 63A               | 2147                                      | 40                    |
|                 |                 | 80A               | 3566                                      | 40                    |
|                 |                 | 100A              | 8450                                      | 40                    |